



### Instructions for saliva specimen collection

**\*Please refrain from eating, drinking, smoking or chewing gum  
for 30 minutes before giving your sample**

#### Procedures:

1. Put on the gloves provided. (This is to prevent cells from your hands contaminating the specimen)
2. Peel open the package and remove the tube.
3. You should be using a pre-labeled MedBio specimen collection tube.
4. Open funnel lid and spit into the funnel until the amount of liquid (not bubbles) reaches the fill line.
5. Hold the tube upright with one hand. Close the funnel lid with the other hand by firmly pushing the lid until you hear a loud click. The liquid in the lid will be released into the tube to mix with the sample. Make sure that the lid is closed tightly.
6. Hold the tube upright. Unscrew the funnel from the tube.
7. Use the small cap to close the tube tightly
8. Shake the capped tube for 10 seconds. Discard the funnel.
9. Place the sealed tube in the sealable biohazard bag provided, leave the absorbent pad in the bag and seal the bag.
10. Return specimens to the MedBio laboratory in BST East 1117 as previously arranged. Samples can be taken to the Center any time within the week they are collected during the hours of 8:00am-4:00pm (only Mon.-Fri.). They can be stored at room temperature.

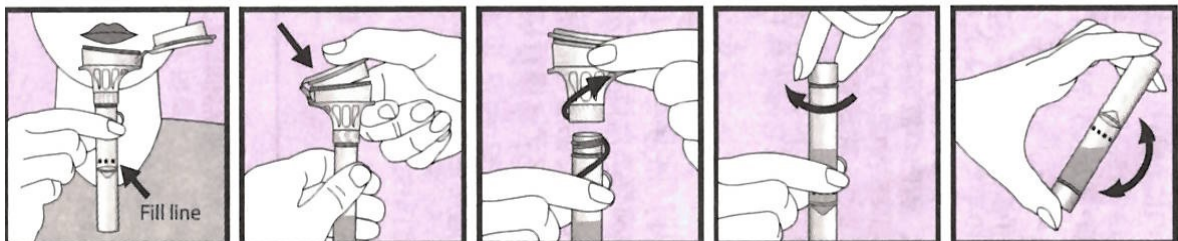

**Warnings and precautions:** The stabilizing liquid is not hazardous but DO NOT INGEST. Wash with water if liquid comes in contact with eyes or skin. Small cap is a choking hazard.

**If you have any questions, please call us at 412-624-8330 or 412-624-2088**